



JA-110P PET Bus PIR motion detector with basic pet immunity

The JA-110P PET is a bus device of the JABLOTRON system. It is used to detect movement of persons in interiors of buildings. Unlike the standard PIR motion detectors from the JABLOTRON 100 series, this detector has a modified detection characteristic and it is equipped with basic pet immunity. The detector eliminates the effects of the movement of small animals on the floor (animals with a weight of up to approx. 25 kg and a maximum height of 40 cm). The detector has a pulse reaction and it takes one position in the system. The detector should be installed by a trained technician with a valid certificate issued by an authorized distributor.



The detector eliminates only the effects of movement of animals on the floor according to the detection characteristics.

It is not suitable for guarding areas where animals can move freely at height!

Installation

The detector can be installed onto a wall or in a corner of a room. Bear in mind that the detector's field of vision should not include any objects which quickly change temperature (electrical heaters, gas appliances, etc.) or which move (curtains hanging above a radiator, robotic vacuum cleaner, etc.). Although the detector is very resistant to false alarms, it is not recommended to install the detector in places with intense air circulation (close to ventilators, air conditioning, vents, unsealed doors, etc.). There should not be any obstacles in the detector's field of vision that would obstruct its view into the guarded area.

The recommended detector installation height is 2 m, maximum height 2.2 m.

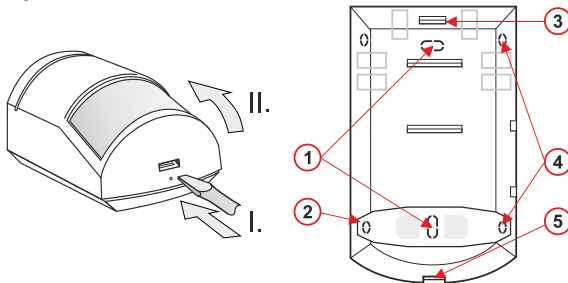

Figure 1.: 1 – holes for installing on a flat wall; 2, 4 – holes for installing at an angle (in a corner); 3 – PCB tab; 5 – cover tab

1. Open the detector cover by pressing the cover tab (5). Avoid touching the PIR sensor inside (11) – you could damage it.
2. Take out the PCB – it is held by a tab (3).
3. Punch through the holes for screws and a cable in the plastic base. The recommended detector installation height is 2 m above the floor.
4. Insert the bus cable and attach the plastic base to the wall with screws (vertically, with the cover tab facing downwards).



When connecting the detector to the bus, always switch the system power off.

5. Insert the PCB back and connect the cables to the terminals (8).

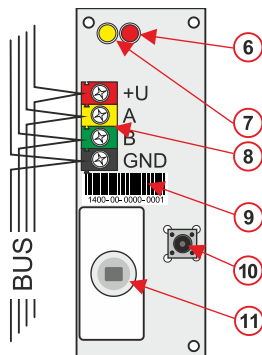

Figure 2.: 6 – red activation LED; 7 – yellow fault LED; 8 – bus terminals; 9 – production code; 10 – cover tamper sensor; 11 – PIR sensor

6. Proceed by following the control panel installation manual.

Basic instructions:

- a. Open the F-Link software, select an unused position in the **Devices** tab and click on the **Enroll** button to enter the **Enrollment mode**.
 - b. Click on the option **Scan/add new bus devices**, select the detector and double-click to confirm selection. The yellow LED goes off.
7. Close the detector cover and test the detector's function.

Notes:

- The detector can also be enrolled into the system by entering its production code in the F-Link software. You can find the production code on the sticker (9) placed on the detector board. All numbers under the bar code must be entered (1400-00-0000-0001).
- The detector can also be enrolled into the system by pressing the cover tamper sensor (10).
- To meet the EN 50131-3 standard it is necessary to secure the cover tab (5) with the supplied screw.

Setting the detector properties

Open the F-Link software, go to the **Devices** tab. Click on the **Internal settings** button at the detector's position to open a dialogue window where you can set:

LED movement indication: Allows you to disable movement indication with a red LED.

Detector testing

When in Service mode, the red LED indicator in the detector indicates every movement, without a reference to settings in the detector properties. Individual activations of the detector can also be monitored in the **Diagnostics** tab in the F-Link software.

Detection characteristics

The detector is fitted with a lens covering 90° / 12 m as standard, see the following figure. In the white part of the diagram the detector eliminates the effects of movement of small animals with a weight of up to approx. 25 kg and a maximum height of 40 cm, in the grey part of the diagram there is standard detection.

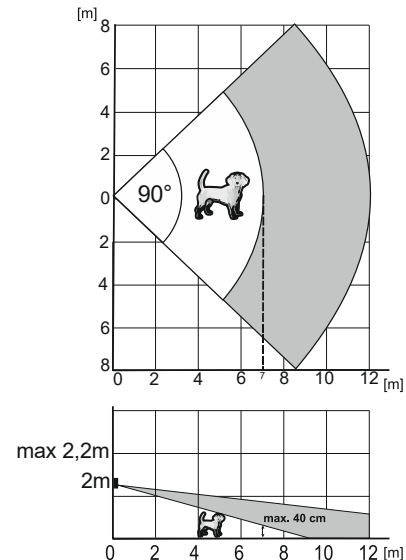

Figure 3.: Detection characteristics

Technical specifications

Power	from the control panel bus, 12 V (8...15 V)
Quiescent current consumption	5 mA
Maximum current consumption	10 mA
Recommended installation height	2 m above the floor
Detection angle / detection coverage	90° / 12 m
Detection angle / detection coverage – pet immunity	90° / 7 m
Dimensions	60 x 98 x 52 mm
Weight	75 g
Classification	Grade 2 / II. indoor general (according to EN 50131-1)
Operational environment	Indoor general
Operational temperature range	-10 °C to +40 °C
Average operational humidity	75% RH, non-condensing
Certification body	Trezor Test s.r.o. (no. 3025), Kiwa Nederland b. v.
Also complies with	EN 50130-4, EN 55032, EN IEC 63000, EN 50131-1, -2-2, T 031
Recommended screw	2x ø 3.5 x 40 mm (countersunk head)



JABLOTRON a.s. hereby declares that the JA-110P PET is in compliance with the relevant European Union harmonisation legislation: Directives No: 2014/30/EU, 2011/65/EU, when used as intended. The original of the conformity assessment can be found at www.jablotron.com – the Downloads section.

Note: Disposing of this product correctly will help save valuable resources and prevent any potential negative effects on human health and the environment, which could otherwise arise from inappropriate waste handling. Please return the product to the dealer or contact your local authority for further details of your nearest designated collection point.