

## The UC-261 wireless indoor siren

The UC-261 indoor siren communicates wirelessly with the control panel (two way communication). It can be used as a wireless indoor siren and at the same time as a melody doorbell or as a chime indicator. The UC-261 is compatible with Jablotron wireless control panels (JA-63 and JA-65), JA-60 wireless detectors and RC-4x, RC-22 and RC-28 remote controls. Several triggering devices can be used simultaneously and different melodies can be assigned to each device. Two different sound levels can be selected. The UC-261 can also provide entrance and exit delay chirps when used with a control panel. In addition, if the UC-261 is disconnected from the power it will send an error report to the control panel.

### Specification

Power supply	230 V, 50 Hz
Power consumption	1 W
Acoustics	8 melodies and/or 100 dB/m alarm siren
Input wireless devices	max. 8 remote controls or detectors 1 control panel, JA-63 or JA-65
Class	II according to EN60950
Working frequency	433.92 MHz
Environmental conditions	indoors -10 to +40°C
Safety standards	IP40 according to EN 60529, IEC 529

Jablotron Ltd. hereby declares that the UC-261 is in compliance with the essential requirements and other relevant provisions of Directive 1999/5/EC.

The original of the conformity assessment can be found at [www.jablotron.com](http://www.jablotron.com), Technical Support section.



### Installation

The UC-261 is powered directly from a power outlet. The device should not be installed close to any metal structures or other objects obstructing radio signal transmissions.

### Enrolling of wireless devices:

1. **To enroll the JA-63 or 65 control panel** switch the control panel to enrollment mode.
2. **While pressing and holding a button on the UC-261, plug it into the outlet** to transmit the enrollment signal.
3. **Release the button** when you hear two beeps. The flashing button indicates that it is in programming mode. Consequently the UC-261 will be enrolled to siren position "A".
4. If another wireless siren has already been enrolled to the control panel, then it is necessary to enroll the UC-261 to a detector position by entering **000000** in control panel enrollment mode before plugging the UC-261 into the outlet (see also the control panel manual).
5. Exit enrollment mode of the control panel by pressing N.
6. If it is necessary to enroll other devices to the UC-261, see following procedure (points 7 to 9). Or **exit programming mode** by briefly pressing the button on the UC-261.

#### NOTE:

- If position "A" is occupied and you plug the UC-261 into the outlet in control panel enrollment mode, then the former item (e.g. JA-60A) will be deleted.
- Only one control panel can be enrolled to the UC-261 but more UC-261 units can be enrolled to one control panel.

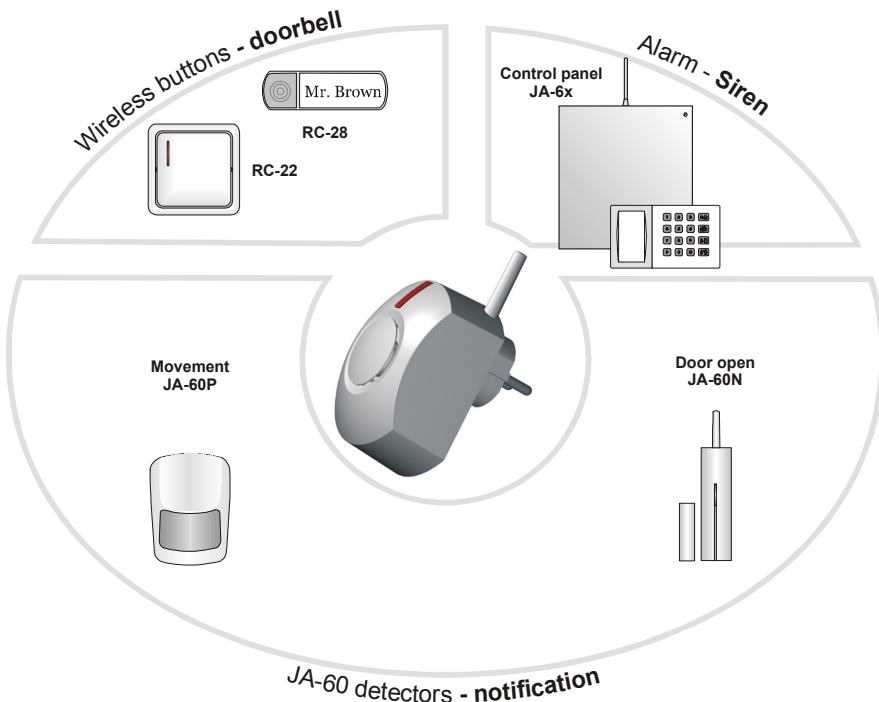

## The UC-261 wireless indoor siren

The UC-261 indoor siren communicates wirelessly with the control panel (two way communication). It can be used as a wireless indoor siren and at the same time as a melody doorbell or as a chime indicator. The UC-261 is compatible with Jablotron wireless control panels (JA-63 and JA-65), JA-60 wireless detectors and RC-4x, RC-22 and RC-28 remote controls. Several triggering devices can be used simultaneously and different melodies can be assigned to each device. Two different sound levels can be selected. The UC-261 can also provide entrance and exit delay chirps when used with a control panel. In addition, if the UC-261 is disconnected from the power it will send an error report to the control panel.

### Specification

Power supply	230 V, 50 Hz
Power consumption	1 W
Acoustics	8 melodies and/or 100 dB/m alarm siren
Input wireless devices	max. 8 remote controls or detectors 1 control panel, JA-63 or JA-65
Class	II according to EN60950
Working frequency	433.92 MHz
Environmental conditions	indoors -10 to +40°C
Safety standards	IP40 according to EN 60529, IEC 529

Jablotron Ltd. hereby declares that the UC-261 is in compliance with the essential requirements and other relevant provisions of Directive 1999/5/EC.

The original of the conformity assessment can be found at [www.jablotron.com](http://www.jablotron.com), Technical Support section.



### Installation

The UC-261 is powered directly from a power outlet. The device should not be installed close to any metal structures or other objects obstructing radio signal transmissions.

### Enrolling of wireless devices:

1. **To enroll the JA-63 or 65 control panel** switch the control panel to enrollment mode.
2. **While pressing and holding a button on the UC-261, plug it into the outlet** to transmit the enrollment signal.
3. **Release the button** when you hear two beeps. The flashing button indicates that it is in programming mode. Consequently the UC-261 will be enrolled to siren position "A".
4. If another wireless siren has already been enrolled to the control panel, then it is necessary to enroll the UC-261 to a detector position by entering **000000** in control panel enrollment mode before plugging the UC-261 into the outlet (see also the control panel manual).
5. Exit enrollment mode of the control panel by pressing N.
6. If it is necessary to enroll other devices to the UC-261, see following procedure (points 7 to 9). Or **exit programming mode** by briefly pressing the button on the UC-261.

#### NOTE:

- If position "A" is occupied and you plug the UC-261 into the outlet in control panel enrollment mode, then the former item (e.g. JA-60A) will be deleted.
- Only one control panel can be enrolled to the UC-261 but more UC-261 units can be enrolled to one control panel.

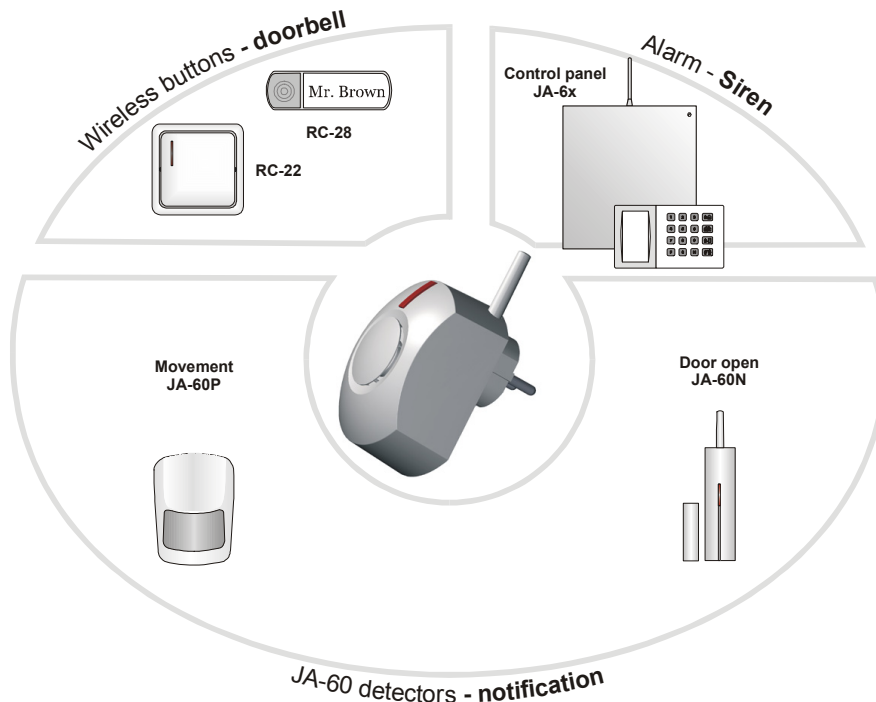

7. **A remote control or doorbell button** (RC-4x, RC-22, RC-28) can be enrolled by pressing the button on the controller. Multiple pressing of the controller's button will allow you to scroll to the desired melody.
8. **Detector-chime mode:** JA-60 detectors can be enrolled by inserting batteries into them, one detector at a time. By triggering the tamper on a detector you can scroll to the desired melody.
9. **Exit programming mode** by briefly pressing the button on the UC-261.

#### Note:

Up to 8 doorbell buttons or detectors can be used with one UC-261.

**If you enter programming mode the above way, all previously enrolled devices will be erased from the UC-261 memory.**

#### Enrolling additional devices

If you want to add additional doorbell buttons or detectors, or if you want to select another melody for an existing device, then:

1. **Unplug the UC-261 from the outlet** and wait for 5 seconds.
2. **Plug it in again.**
3. **When the button lights – press it and hold it down. After hearing a short beep, release the button.** The flashing button indicates that it is in programming mode.

#### 4. Enrolling new devices (or selecting another melody):

- **A doorbell button or remote control** (RC-4x, RC-22, RC-28) can be enrolled by pressing the button on the controller. Multiple pressing of the controller's button will allow you to scroll to the desired melody.
- **Detector-chime mode:** JA-60 detectors can be enrolled by inserting batteries into them, one detector at a time. By triggering the tamper on a detector you can scroll to the desired melody.

5. **Exit programming mode** by briefly pressing the button on the UC-261.

#### Deleting enrolled devices

Press and hold the button on the UC-261 and plug the UC-261 into the mains outlet. Two beeps will be heard and all devices **including the control panel** will then be erased.

Consequently it is necessary to erase the UC-261 from the control panel. In control panel enrollment mode scroll to the UC-261 position, press and hold button 2 until the confirmation beep can be heard.

Note: If the memory of the UC-261 is deleted but the UC-261 is not erased from the control panel, then the control panel will indicate disconnection of the UC-261 from the power but **the UC-261 will not react to signals from the control panel – in the case of an alarm it will not sound.**

#### Loudness selection

- The UC-261 must be in its normal operating mode (plugged in).
- Press and hold the button down.
- After 2 seconds you will hear a melody with the new loudness selected
- Release the button.

*This way you can toggle between a standard and a quieter level. This setting does not affect the alarm siren sound.*

#### Power failure

If the UC-261 is disconnected from its power (it is unplugged or there is a power failure), then a "Low battery" report will be transmitted to the control panel. In addition if the system is in alarm mode (the sirens are sounding) the UC-261 will also transmit a "TAMPER" signal.

#### Doorbell-mode

After pressing a doorbell button, the UC-261 will play a preselected melody. Different melodies can be assigned to each doorbell button, if desired. If you want to change a melody, enter programming mode (see section "Enrolling Additional Devices") and press the button until the desired melody is selected.

#### Detector-chime mode

If an enrolled detector is triggered, the UC-261 will play a pre-selected melody. The melody can be changed if desired (see section "Enrolling Additional Devices").

A detector enrolled to the UC-261 can be simultaneously enrolled to a JA-63 or JA-65 control panel. This way, for example, a wireless door detector can activate a chime on the UC-261 and at the same time trigger an alarm.

#### Notes:

- 1/ *The JA-60P motion detector has a special sleep mode feature (settable to 5 min. or 1 min.). Therefore it cannot detect more frequent movements in a covered area.*
- 2/ *The JA-60SP, JA-60SR fire detectors and JA-60G cannot be used for chime mode.*

#### Wireless siren mode

The UC-261's light indicator shows the status of the PgY output of the enrolled control panel. If an alarm is triggered, the UC-261 siren sounds. ARM and DISARM chirps can be enabled or disabled by the following procedure:

1. **Unplug the UC-261 from the outlet** and wait for 5 seconds.
2. **Plug it in again.**
3. **When the button lights – press it and hold it down. After hearing a short beep, release the button.** The flashing button indicates that it is in programming mode.
4. **On the control panel in P mode enter 299 repeatedly to toggle between these two settings:**

- When **one** beep is heard, no chirps will be performed by the UC-261.
- When **two** beeps are heard, both ARM and DISARM chirps will be performed by the UC-261.



**Note:** Although this product does not contain any harmful materials we suggest you return the product to the dealer or directly to the producer after use.



Pod Skalkou 33  
466 01 Jablonec nad Nisou  
Czech Republic  
Tel.: +420 483 559 999  
fax: +420 483 559 993  
Internet: www.jablotron.cz

7. **A remote control or doorbell button** (RC-4x, RC-22, RC-28) can be enrolled by pressing the button on the controller. Multiple pressing of the controller's button will allow you to scroll to the desired melody.
8. **Detector-chime mode:** JA-60 detectors can be enrolled by inserting batteries into them, one detector at a time. By triggering the tamper on a detector you can scroll to the desired melody.
9. **Exit programming mode** by briefly pressing the button on the UC-261.

#### Note:

Up to 8 doorbell buttons or detectors can be used with one UC-261.

**If you enter programming mode the above way, all previously enrolled devices will be erased from the UC-261 memory.**

#### Enrolling additional devices

If you want to add additional doorbell buttons or detectors, or if you want to select another melody for an existing device, then:

1. **Unplug the UC-261 from the outlet** and wait for 5 seconds.
2. **Plug it in again.**
3. **When the button lights – press it and hold it down. After hearing a short beep, release the button.** The flashing button indicates that it is in programming mode.

#### 4. Enrolling new devices (or selecting another melody):

- **A doorbell button or remote control** (RC-4x, RC-22, RC-28) can be enrolled by pressing the button on the controller. Multiple pressing of the controller's button will allow you to scroll to the desired melody.
- **Detector-chime mode:** JA-60 detectors can be enrolled by inserting batteries into them, one detector at a time. By triggering the tamper on a detector you can scroll to the desired melody.

5. **Exit programming mode** by briefly pressing the button on the UC-261.

#### Deleting enrolled devices

Press and hold the button on the UC-261 and plug the UC-261 into the mains outlet. Two beeps will be heard and all devices **including the control panel** will then be erased.

Consequently it is necessary to erase the UC-261 from the control panel. In control panel enrollment mode scroll to the UC-261 position, press and hold button 2 until the confirmation beep can be heard.

Note: If the memory of the UC-261 is deleted but the UC-261 is not erased from the control panel, then the control panel will indicate disconnection of the UC-261 from the power but **the UC-261 will not react to signals from the control panel – in the case of an alarm it will not sound.**

#### Loudness selection

- The UC-261 must be in its normal operating mode (plugged in).
- Press and hold the button down.
- After 2 seconds you will hear a melody with the new loudness selected
- Release the button.

*This way you can toggle between a standard and a quieter level. This setting does not affect the alarm siren sound.*

#### Power failure

If the UC-261 is disconnected from its power (it is unplugged or there is a power failure), then a "Low battery" report will be transmitted to the control panel. In addition if the system is in alarm mode (the sirens are sounding) the UC-261 will also transmit a "TAMPER" signal.

#### Doorbell-mode

After pressing a doorbell button, the UC-261 will play a preselected melody. Different melodies can be assigned to each doorbell button, if desired. If you want to change a melody, enter programming mode (see section "Enrolling Additional Devices") and press the button until the desired melody is selected.

#### Detector-chime mode

If an enrolled detector is triggered, the UC-261 will play a pre-selected melody. The melody can be changed if desired (see section "Enrolling Additional Devices").

A detector enrolled to the UC-261 can be simultaneously enrolled to a JA-63 or JA-65 control panel. This way, for example, a wireless door detector can activate a chime on the UC-261 and at the same time trigger an alarm.

#### Notes:

- 1/ *The JA-60P motion detector has a special sleep mode feature (settable to 5 min. or 1 min.). Therefore it cannot detect more frequent movements in a covered area.*
- 2/ *The JA-60SP, JA-60SR fire detectors and JA-60G cannot be used for chime mode.*

#### Wireless siren mode

The UC-261's light indicator shows the status of the PgY output of the enrolled control panel. If an alarm is triggered, the UC-261 siren sounds. ARM and DISARM chirps can be enabled or disabled by the following procedure:

1. **Unplug the UC-261 from the outlet** and wait for 5 seconds.
2. **Plug it in again.**
3. **When the button lights – press it and hold it down. After hearing a short beep, release the button.** The flashing button indicates that it is in programming mode.
4. **On the control panel in P mode enter 299 repeatedly to toggle between these two settings:**

- When **one** beep is heard, no chirps will be performed by the UC-261.
- When **two** beeps are heard, both ARM and DISARM chirps will be performed by the UC-261.



**Note:** Although this product does not contain any harmful materials we suggest you return the product to the dealer or directly to the producer after use.



Pod Skalkou 33  
466 01 Jablonec nad Nisou  
Czech Republic  
Tel.: +420 483 559 999  
fax: +420 483 559 993  
Internet: www.jablotron.cz